

535, 536, 537 & 538 Series Cabinet, Door & Appliance Pulls

Finishes for Life
TARNISH-FREE GUARANTEED

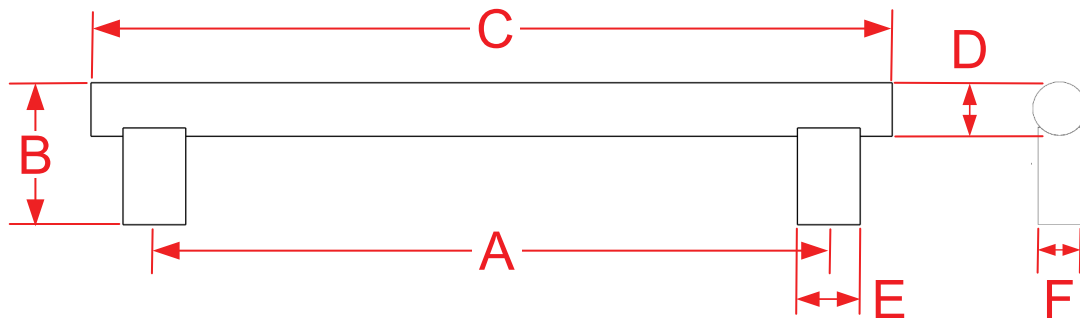

Part #	A Center to Center	B Projection	C Overall	D Diameter	E Base Length	F Base Width
535-3	3.0000"	1.3750"	4.0000"	0.5000"	0.6250"	0.3750"
535-4	4.0000"	1.3750"	5.0000"	0.5000"	0.6250"	0.3750"
535-6	6.0000"	1.3750"	7.0000"	0.5000"	0.6250"	0.3750"
535-8	8.0000"	1.2500"	9.0000"	0.5000"	0.6250"	0.3750"
Custom sizing available up to 25" overall						
536-6	6.0000"	1.6875"	7.5000"	0.6250"	0.7500"	0.5000"
536-8	8.0000"	1.6875"	9.5000"	0.6250"	0.7500"	0.5000"
536-10	10.0000"	1.6875"	11.5000"	0.6250"	0.7500"	0.5000"
Custom sizing available up to 30" overall					Page 1 of 2	



Manufacturing Fine Architectural Hardware
in the USA Since 1927



Copyright 2015
Colonial Bronze Company
All rights reserved
www.colonialbronze.com -
860.489.9233

535, 536, 537 & 538 Series Cabinet, Door & Appliance Pulls

Finishes for Life
TARNISH-FREE GUARANTEED

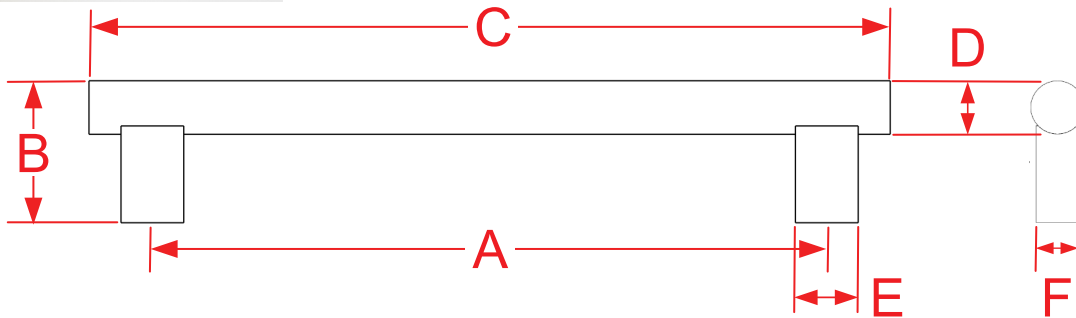

Part #	A Center to Center	B Projection	C Overall	D Diameter	E Base Length	F Base Width
537-6	6.0000"	2.0000"	8.0000"	0.7500"	1.0000"	0.6250"
537-8	8.0000"	2.0000"	10.0000"	0.7500"	1.0000"	0.6250"
537-10	10.0000"	2.0000"	12.0000"	0.7500"	1.0000"	0.6250"
537-12	12.0000"	2.0000"	14.0000"	0.7500"	1.0000"	0.6250"
Custom sizing available up to 30" overall						
538-8	8.0000"	2.6250"	10.5000"	1.0000"	1.0000"	0.7500"
538-10	10.0000"	2.6250"	12.5000"	1.0000"	1.0000"	0.7500"
538-12	12.0000"	2.6250"	14.5000"	1.0000"	1.0000"	0.7500"
538-18	18.0000"	2.6250"	20.5000"	1.0000"	1.0000"	0.7500"
538-24	24.0000"	2.6250"	26.5000"	1.0000"	1.0000"	0.7500"
Custom sizing available up to 30" overall					Page 1 of 2	



Manufacturing Fine Architectural Hardware
in the USA Since 1927



Copyright 2015
Colonial Bronze Company
All rights reserved
www.colonialbronze.com -
860.489.9233